

# VIATrack Track Section

## Concrete Flat Slab

Reference Instructions Sheet

411

Rev  
A

37 pcs

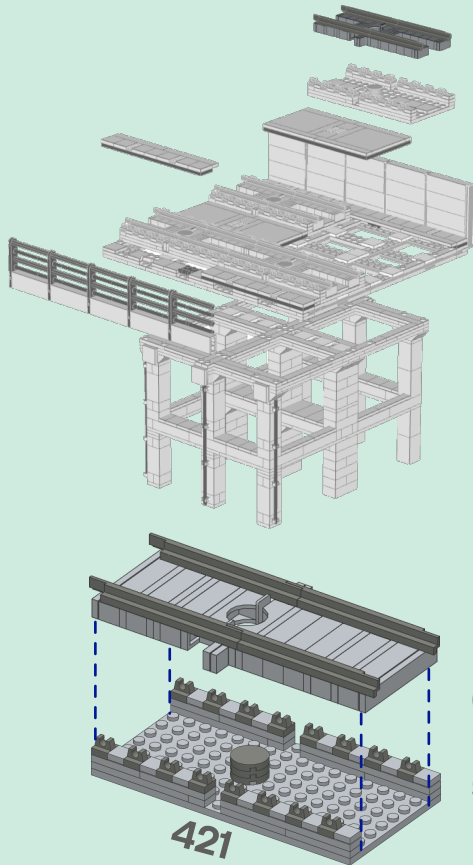

Combine with 421 to  
make complete track  
section assembly

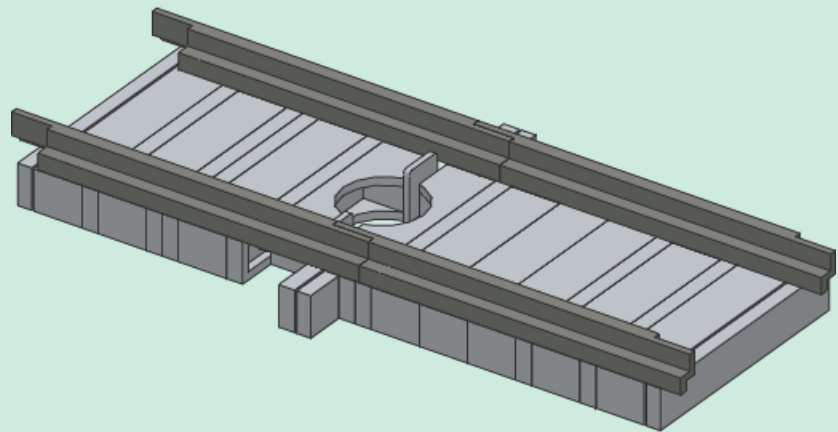

## Parts List

### Notes

This assembly requires 2x  
straight rail sections.  
Acceptable rail elements  
include:  
4x ME901-HF or  
2x ME901-ST or  
2x ME901-DB from ME Models  
or  
3228c or 3228b from LEGO

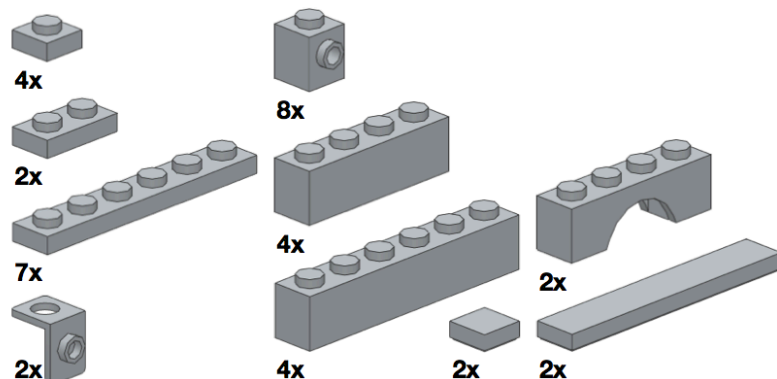

# 1

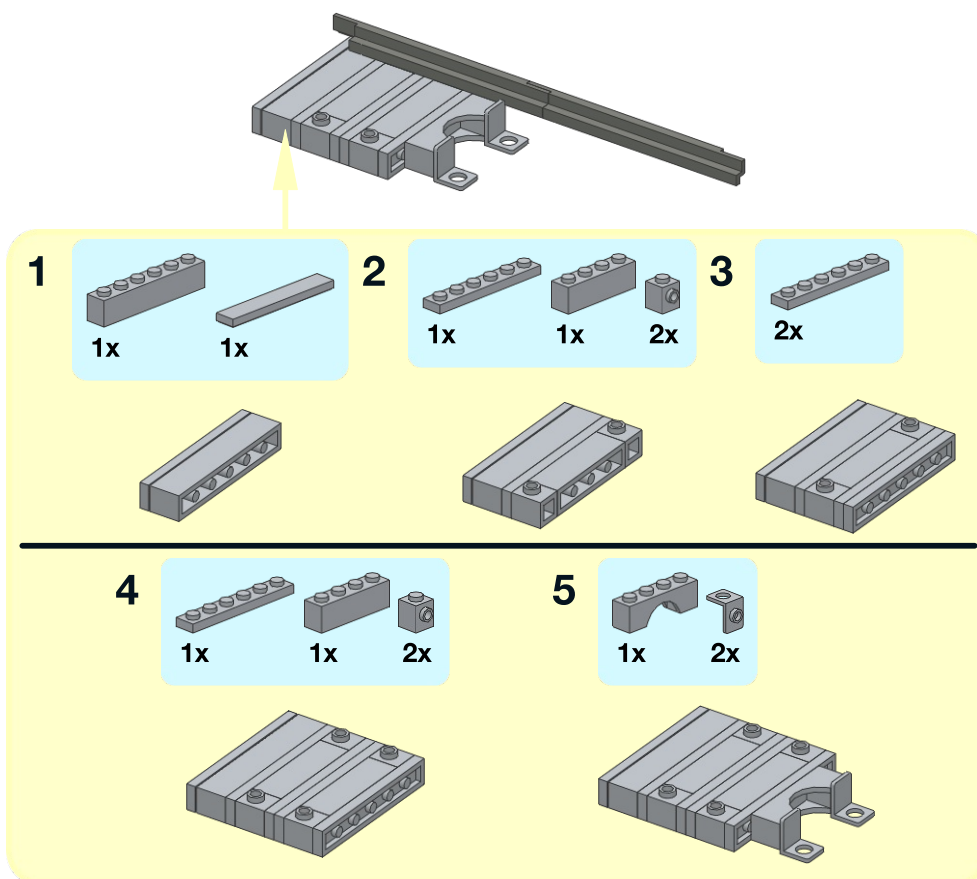

# 2

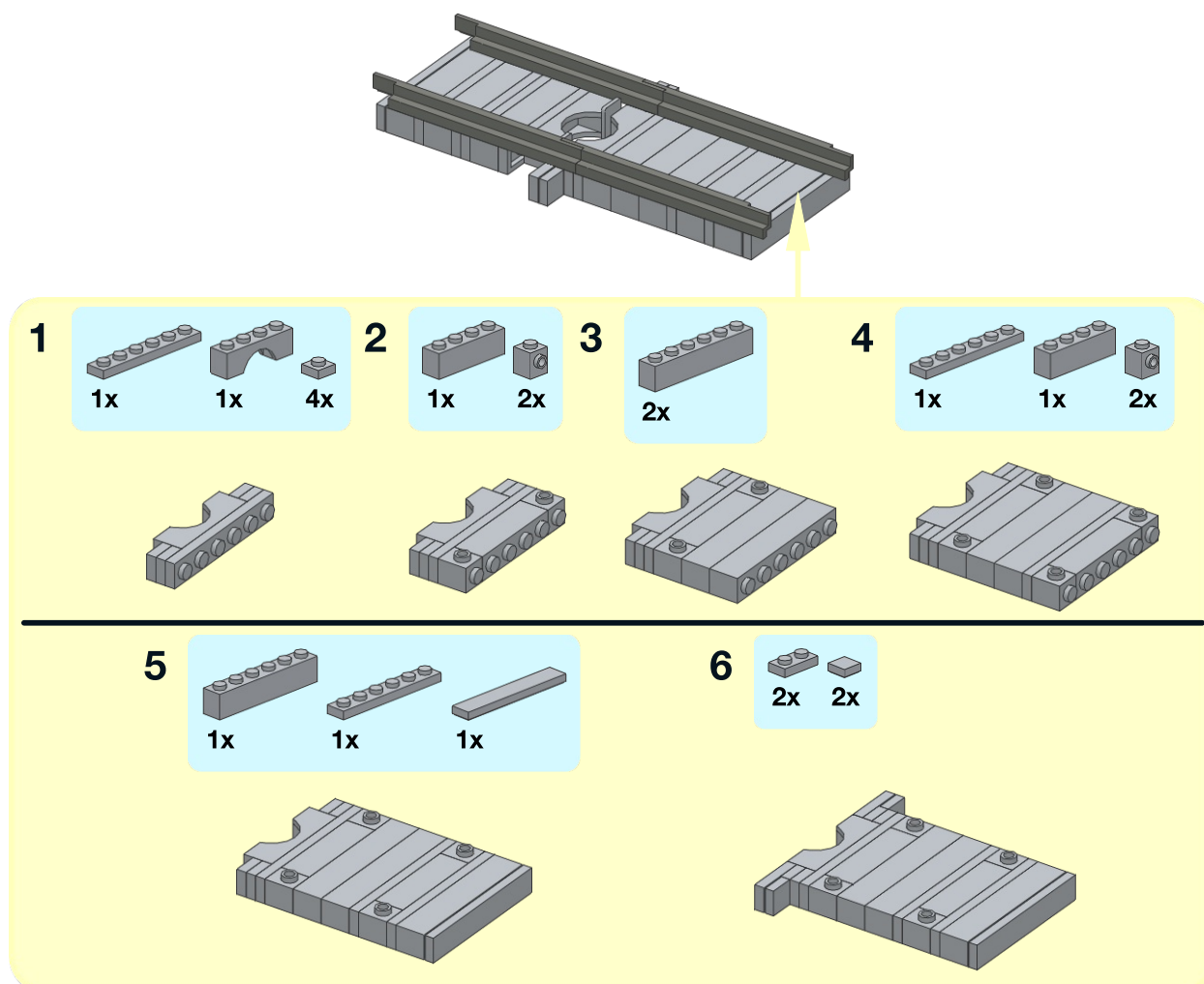

# 1