

# Ballasted R88 Curve Track

PennLUG  
variation

Reference Instructions Sheet

008

Rev  
A

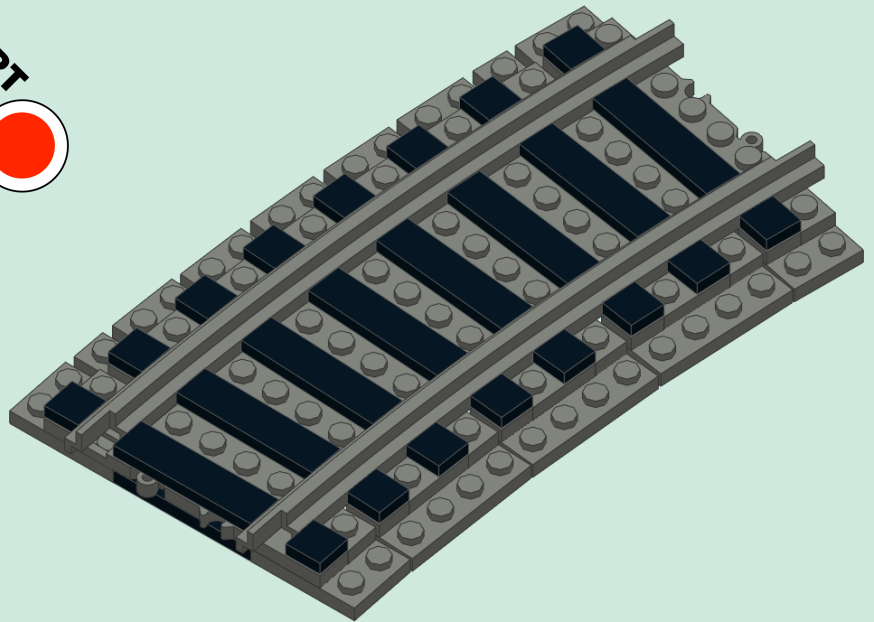
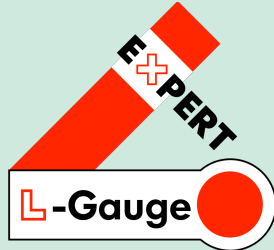
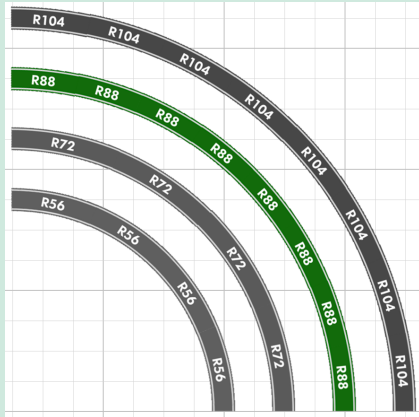

These instructions use techniques which may induce mechanical stress on individual parts. Use at your own risk.

Ballast method designed by Anthony Sava

## Parts List

### Notes

Instructions are for a single curve track section. Multiply part quantity as required for multiple curves. 32x required for complete circle.

This ballast method requires ME Models R88 curves (P/N ME901-88)

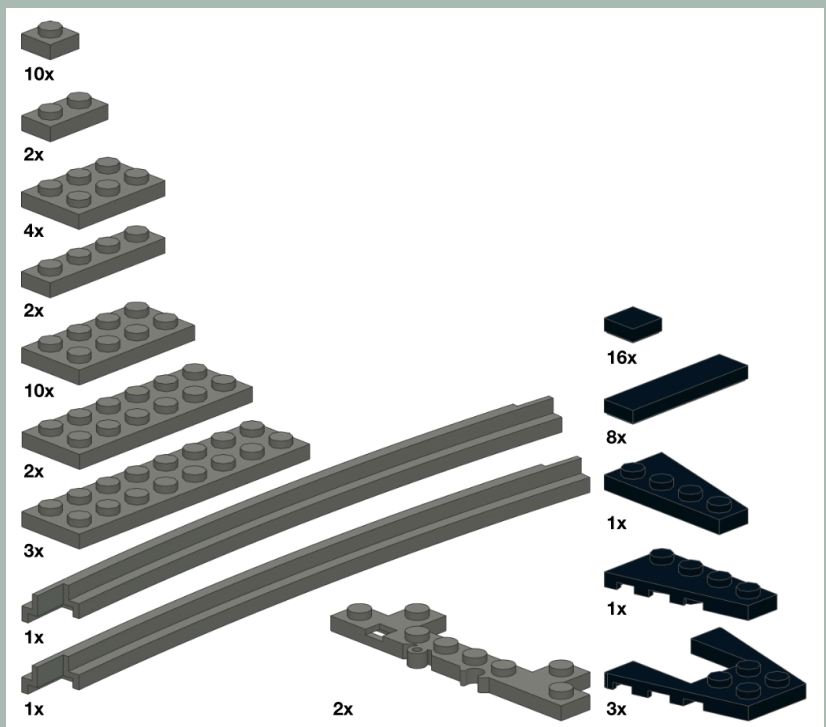

1

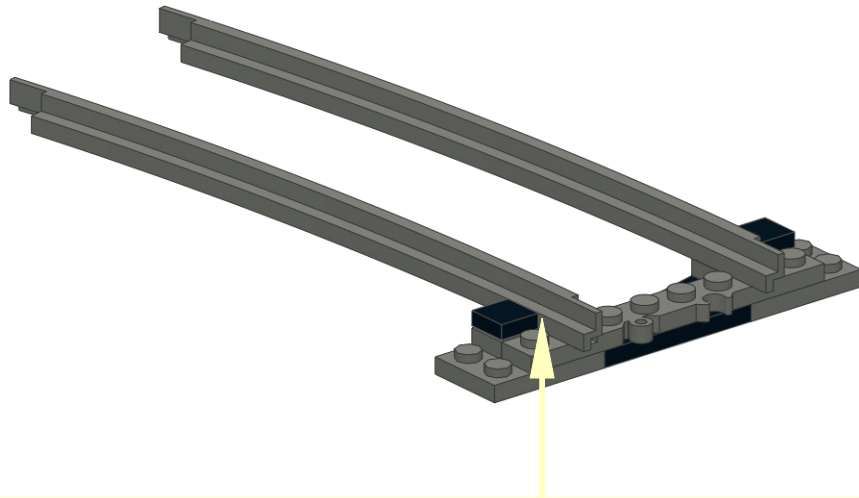
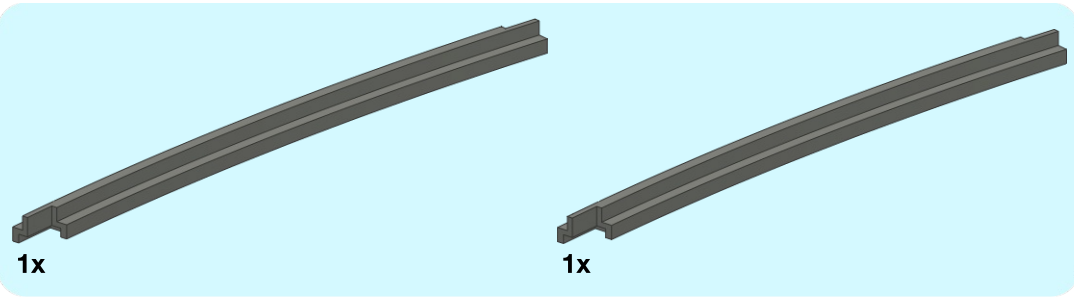

1

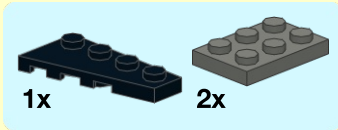

2

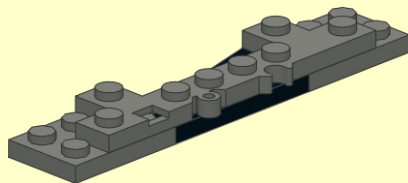
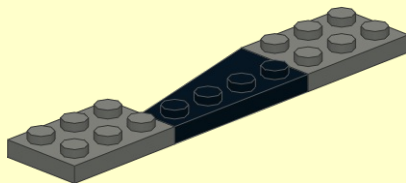
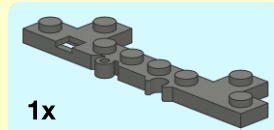

3

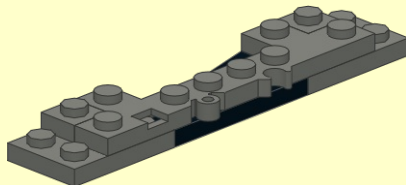

4

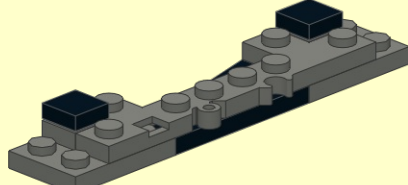

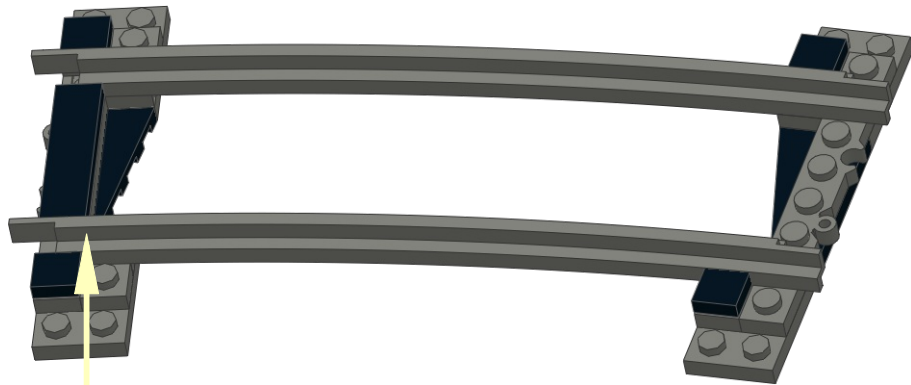

1

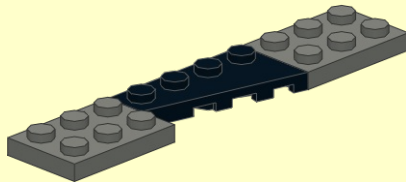
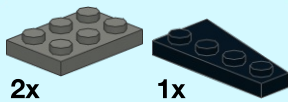

2

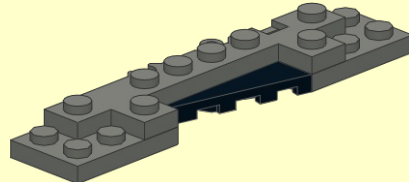
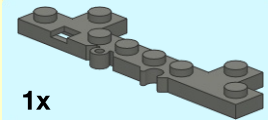

3

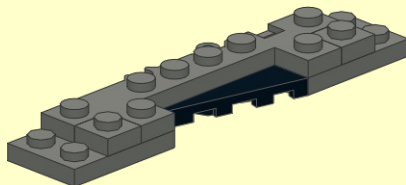

4

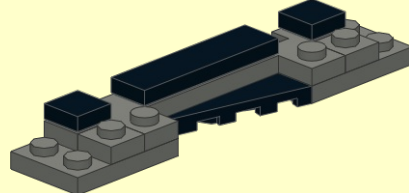
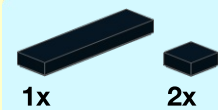

3

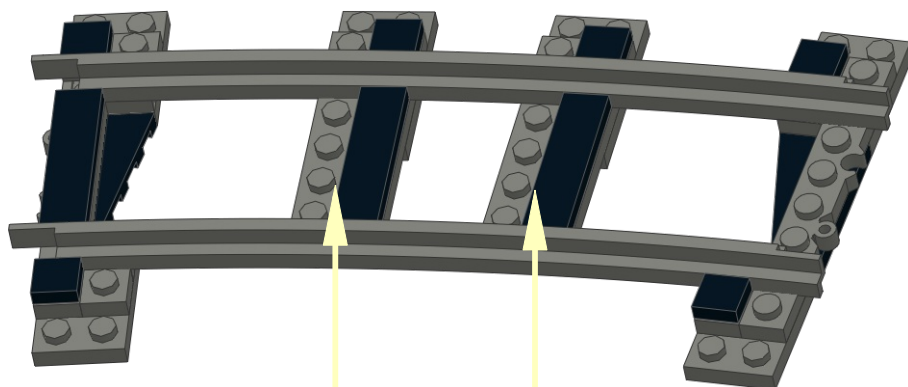

1



1x

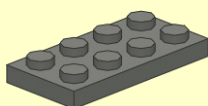

2



1x

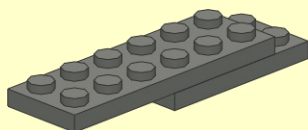

3



1x



1x

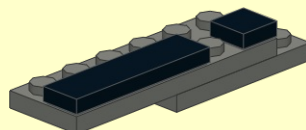

x2

4

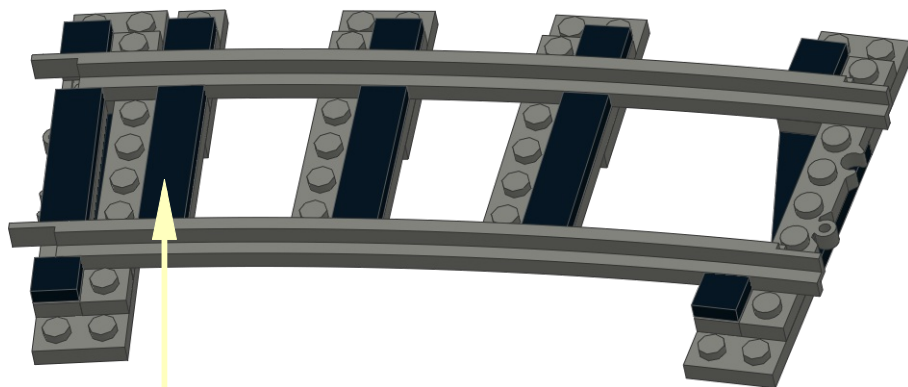

1

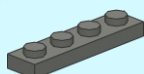

1x

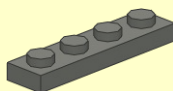

2



1x



1x

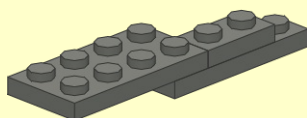

3



1x



1x

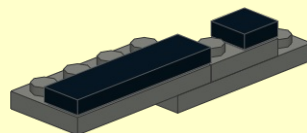

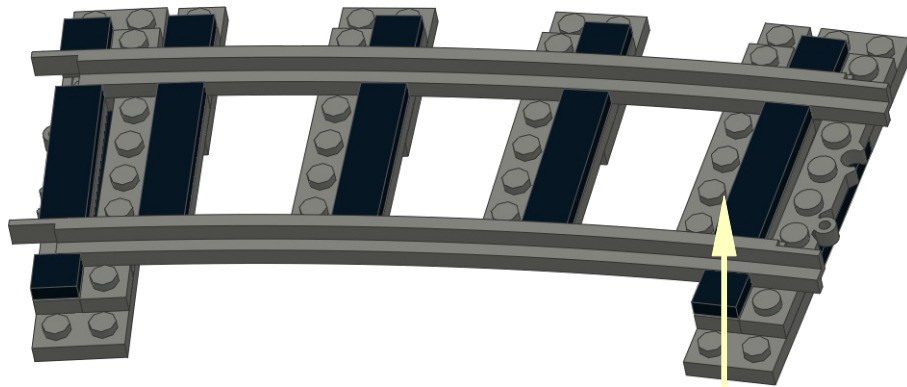

1

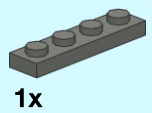

1x

2

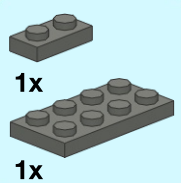

1x

1x

3

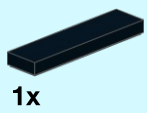

1x

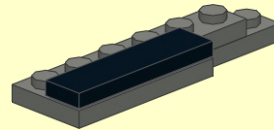
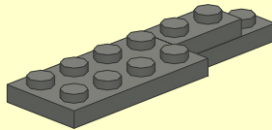
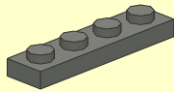

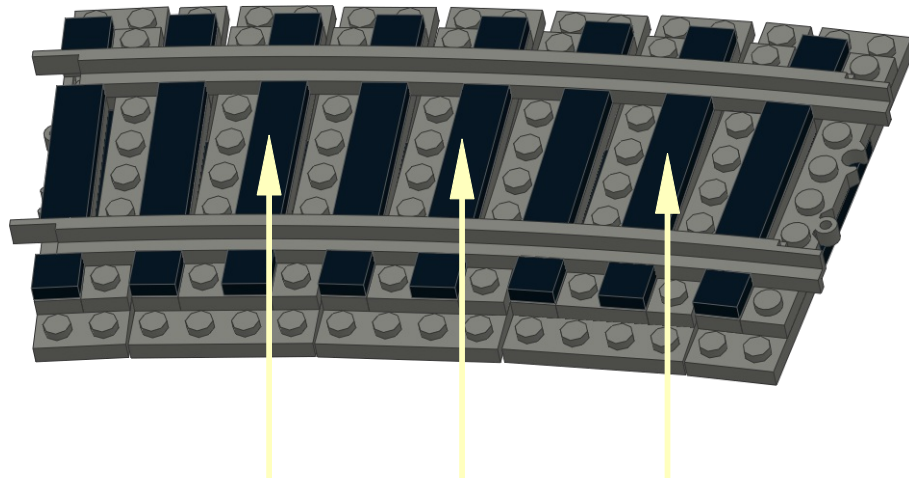

1

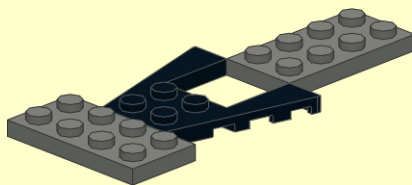
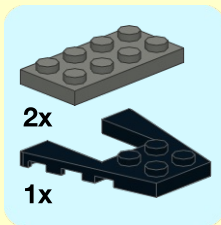

2

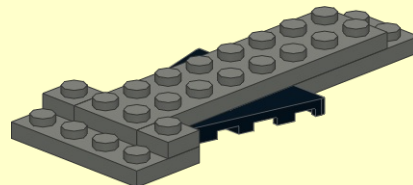
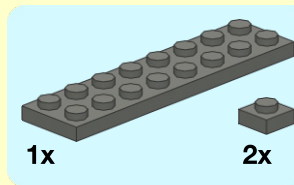

3

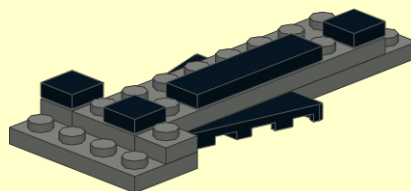
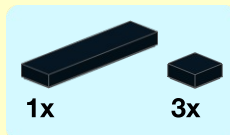

x3